

Soils Map

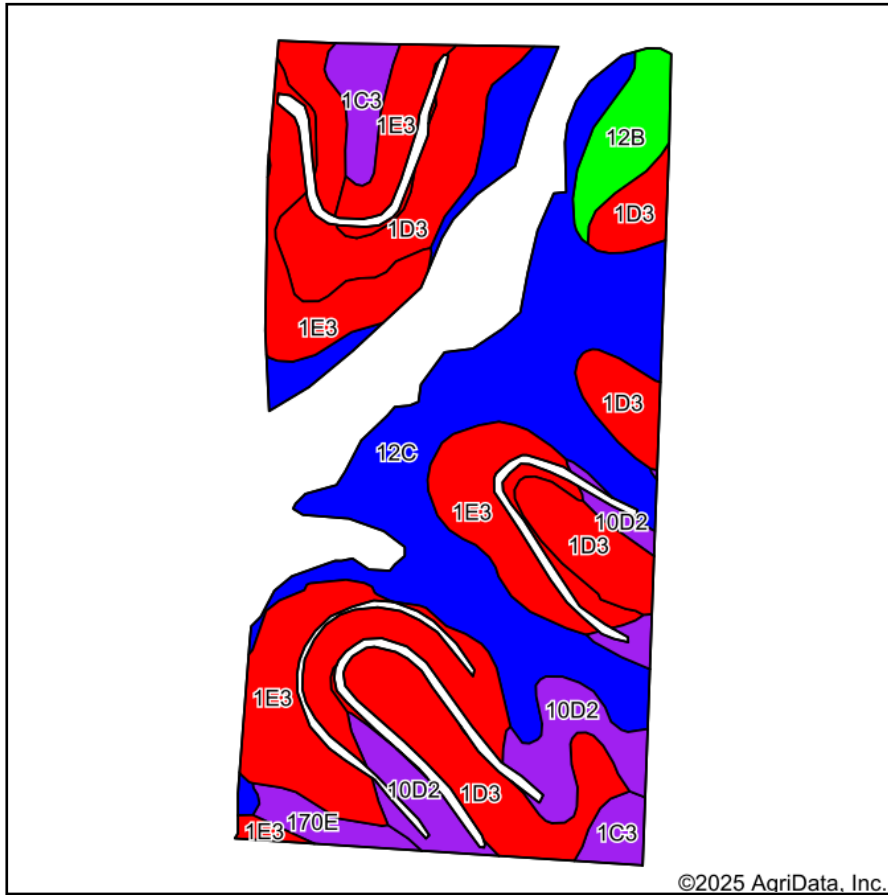

Soils data provided by USDA and NRCS.

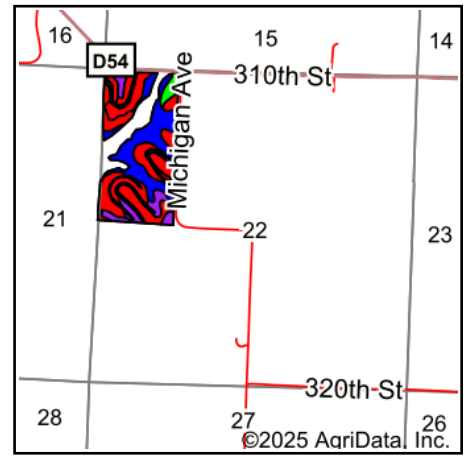

State: **Iowa**
 County: **Woodbury**
 Location: **22-86N-43W**
 Township: **Oto**
 Acres: **58.62**
 Date: **12/9/2025**

AgCentric
 Farm Agency, LLC
 712-277-2741

Maps Provided By:

 CUSTOMIZED ONLINE MAPPING
 © AgriData, Inc. 2025 www.AgriDataInc.com



Area Symbol: IA193, Soil Area Version: 35

Code	Soil Description	Acres	Percent of field	CSR2 Legend	Non-Irr Class *c	CSR2**	CSR	*n NCCPI Overall
12C	Napier silt loam, 5 to 9 percent slopes	18.59	31.8%		IIIe	89	58	87
1E3	Ida silt loam, 14 to 20 percent slopes, severely eroded	15.49	26.4%		IVe	18	28	57
1D3	Ida silt loam, 9 to 14 percent slopes, severely eroded	14.54	24.8%		IIIe	32	37	60
10D2	Monona silt loam, 9 to 14 percent slopes, eroded	4.60	7.8%		IIIe	60	47	76
1C3	Ida silt loam, 5 to 9 percent slopes, severely eroded	2.18	3.7%		IIIe	58	46	63
12B	Napier silt loam, 2 to 5 percent slopes	2.15	3.7%		Ile	93	72	89
170E	Napier-Castana silt loams, 9 to 20 percent slopes	1.07	1.8%		IIIe	56	34	78
Weighted Average					3.23	52.2	43.6	*n 70.5

**IA has updated the CSR values for each county to CSR2.

*n: The aggregation method is "Weighted Average using all components"

*c: Using Capabilities Class Dominant Condition Aggregation Method

Soils data provided by USDA and NRCS.